

Universal anchor SDF-KB-10H

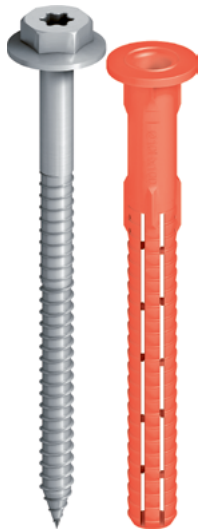

Application range

- > Installation of metal attachments
- > For multiple fastening of non-load-bearing systems according to EAD 330284
- > Suitable for the structural fastening of wall cupboards, cladding, metal angle pieces
- > For embedment in rain screens
- > For application as single fastening in concrete

Properties

- > Hexagon head with flange
- > Approved for all common building materials
- > Reliable hold in problematic building materials thanks to optimised expansion part
- > Radial expansion for reliable hold
- > Product identification through different sleeve colours
- > Double safety lock against torsion for secure installation

Note

For planning and processing, please observe ETA-10/0305 and Z-21.2-2122. Further information about parameters and loads can be found in the approvals. For bricks of unknown quality, the load-bearing capacity must be determined through pull-out tests on the structure.

Cross references	page
Cleaning brush	429
Blow-out pump	430
Tool belt	425
Corrosion protection spray	431
Hammer drill SDS plus	407
Cordless screwdriver ASCM	394
Cordless hammer drill	398
Socket wrench insert SW13	416
Bit hexabular TX30	413
Duster Expert SDS plus®	411

Admissible loads

Tensile load $N_{Rk,p}$ in concrete C12/15

Temperature range 30 °C / 50 °C	1.79 kN
Temperature range 50 °C / 80 °C	1.59 kN

Brick Mz 20-1.8, NF	1.14 kN
Solid sand-lime brick KS 36, NF	1.29 kN
Solid sand-lime brick KS 20, 8 DF	1.29 kN
Solid lightweight concrete brick V6, 2 DF	0.57 kN
Vertically perforated brick HLZ 12-0.9, NF	0.57 kN
Perforated sand-lime brick KSL 12, 4 DF	0.71 kN
Cavity block made of lightweight concrete Hbl 10, 12 DF	0.34 kN

Transverse load $V_{Rk,s}$

Steel screw ($\gamma Ms = 1.25$)	7.48 kN
Stainless steel screw ($\gamma Ms = 1.56$)	6.99 kN

Bending moment $M_{Rk,s}$

Steel screw ($\gamma Ms = 1.25$)	14.14 Nm
Stainless steel screw ($\gamma Ms = 1.56$)	13.22 Nm

Compressive strength of aerated concrete [N/mm²] 30–50 °C

Aerated concrete $f_b \geq 4$ N/mm ²	0.54 kN
Aerated concrete $f_b \geq 5$ N/mm ²	0.71 kN
Aerated concrete $f_b \geq 6$ N/mm ²	0.89 kN
Aerated concrete $f_b \geq 7$ N/mm ²	0.89 kN

Applications

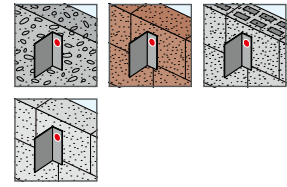

Technical specifications

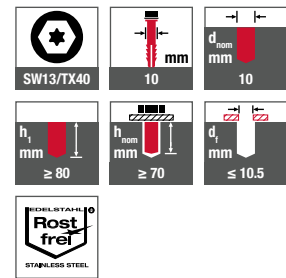

Certifications

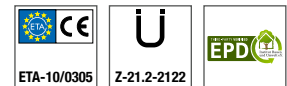

Base materials

- Approved for
- > Cracked concrete
 - > Non-cracked concrete
 - > Solid masonry
 - > Hollow and perforated bricks
 - > Aerated concrete

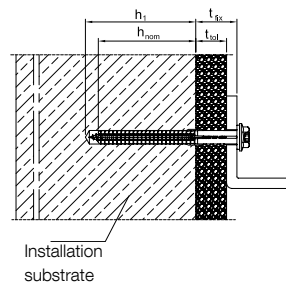

Installation substrate





Product online



Order description	Length [mm]	Fastening thickness t_{tx} ≤ [mm]	PU [pieces]	Price/100 [EUR]	Article number	EAN
Anchors with steel screws with zinc-plated Cr(VI)-free coating (-V)						
SDF-KB-10Hx80-V	80	10	100		8513080420	4061245019642
SDF-KB-10Hx100-V	100	30	50		8513100420	4061245019611
SDF-KB-10Hx120-V	120	50	50		8513120420	4061245019581
SDF-KB-10Hx140-V	140	70	50		8513140420	4061245019567
Anchors with A4 stainless steel screws (-E)						
SDF-KB-10Hx80-E	80	10	100		8513080620	4061245019635
SDF-KB-10Hx100-E	100	30	50		8513100620	4061245019604
SDF-KB-10Hx120-E	120	50	50		8513120620	4061245019574
SDF-KB-10Hx140-E	140	70	50		8513140620	4061245019550

Further lengths
available upon request

